

# **The Champions**

## **Borehamwood, WD6**



- Three Bedrooms
  - Driveway
  - Eat in Kitchen
- Conservatory
- South-Facing Garden
- Guest wc

We are delighted to present this well-maintained three bedroom semi-detached family home, quietly situated at the back of a popular development in Borehamwood. This sought-after location offers a variety of local amenities, excellent schools, and convenient transport links.

The ground floor comprises, spacious reception room, guest wc and eat in kitchen leading to a bright conservatory.  
The first floor offers three good size bedrooms and a family bathroom.

Further benefits include a south-facing garden with a patio area perfect for entertaining, and off-street parking. There is also potential to extend STPP.

**Asking price £535,000**





**The Champions WD6 5QD**  
Gross Internal Area 1227 sq ft /114 sq metres

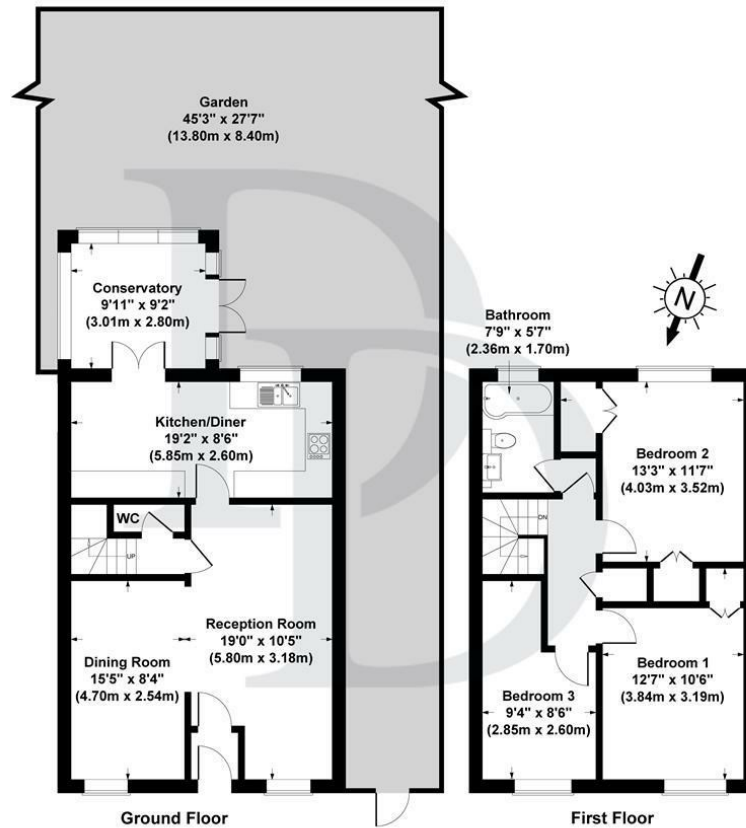

All measurements of walls, doors, windows, fittings and appliances, including their size and location, are shown as standard sizes and therefore cannot be regarded as a representation by the seller.

  
DANI DENBY

